

Installation manual for the Ferrari Mondial Rear Window Glass

V 1.0

Applies to:

Ferrari Mondial 8 Coupe

Ferrari Mondial Quattrovalvole 3.0L Coupe

Ferrari Mondial Quattrovalvole 3.2L Coupe

Ferrari Mondial T 3.4L Coupe

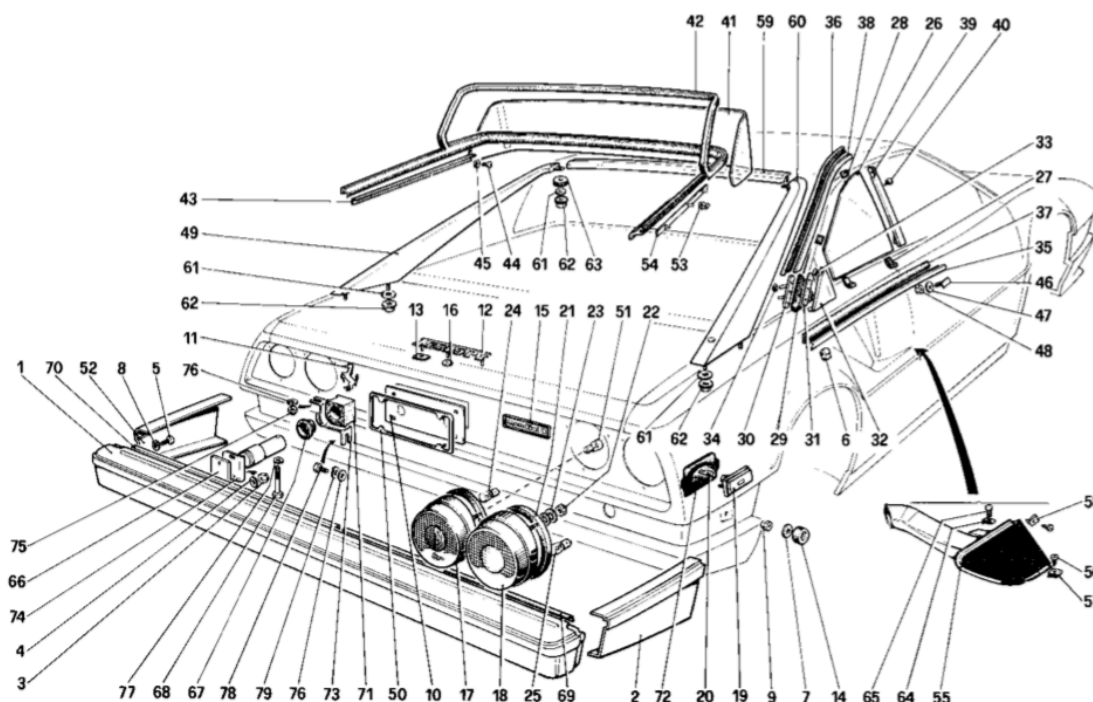

Author: Stefan Leunis

Ferrarichat user stekkefun4

**Disclaimer:**

- Please read this manual very carefully and attentively before starting the work
- For the installation of the window glass, at least 2 persons are required, optionally a third one to supervise and encourage the other 2 and providing them with relaxing music and gentle words
- Please use a new window gasket (#42) or one that is in perfect condition and doesn't have any rips or tears or is deformed. A gasket consists of a top, bottom, left and right strip, and form all together one single structure
- The instructions refer to the technical schema numbers on the first page.
- The structure of glass is between liquid and solid state, so please make sure the tension is distributed equally over the glass surface, thus avoiding cracks. A very good way of distributing the pressure, is to tape the window with several bands of tape running from the far left to the far right corner
- Make sure that no glass pieces from a previous window are left in the frame where the new glass will fit in. Clean up the work area where the glass will be fit in first.
- Prior to installing the new window, make sure the ceiling and both LH and RH side trim panels have been removed to have full access to the rear window.
- Keep calm under all circumstances

Steps for installing the window glass

1. **Lubricate the edge of the frame** with simple grease or vaseline, so the rubber gasket (#42) will easily slide over the metal edge of the frame.
2. **To distribute the pressure on the glass** (#41) you have to tape the glass surface as you see here on the picture. Tape from the far left to the far right side of the glass, do that on both front and back sides of the glass.



3. **There is only one way to push the glass into its position:** from the interior outwards, meaning that one person should hold the glass, seated on the rear seats and the second person stands on the left or right hand side of the car next to the engine compartment.
4. It is best practice to **put the gasket around the window glass** before installing and NOT installing the gasket on the metal edge of the frame first.
5. Person in the car: take the window glass with the fitted gasket in your hands and **gently push both LH and RH parts of the window into the corners as far as possible**, only applying soft pressure on the glass.
6. Person standing outside: **pull the bottom strip of the gasket gently over the bottom edge of the frame** from the far left to the far right so that the bottom part of the gasket is already in place.

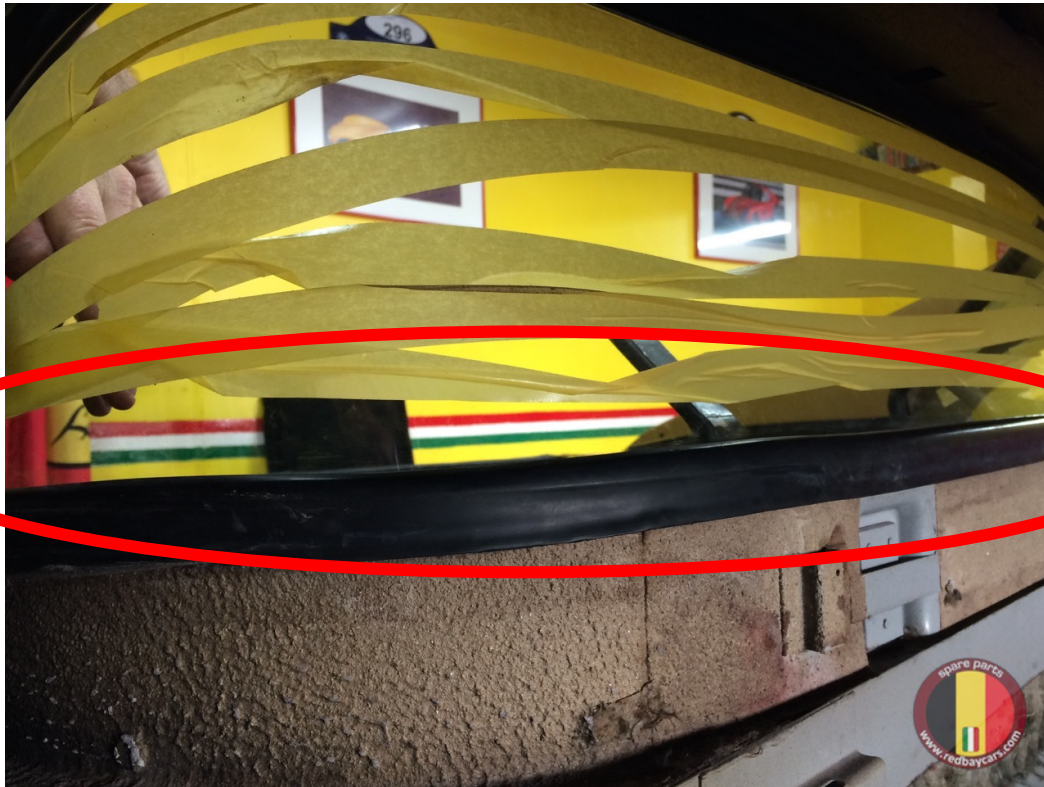

7. Person in the car: **push the far LH and RH sides of the glass as further into the corners of the frame.** Do not put too much pressure on the glass: take your time and do it RH and LH sides in turn. At this time, the glass will not fully reach the corners yet, so don't use too much pressure!
8. Person standing outside: **pull the upper side of the rubber gasket gently over the edge of the frame,** starting from the far RH and LH corners. Best practice is to pull the rubber



over the edge with your fingers and very slowly continuing upwards. Optionally, you could use a small plastic spatula to pull the rubber over the metal edge.

This step may require 15 minutes to perform, make sure the rubber fits over the metal edge for 100% over the entire length.



9. Now that the window with gasket is successfully pushed in its place, both LH and RH side **metal place holders (#54) can be shoved in the gasket (#42).**
10. Gently **push the plugs of the metal place holders (#54) in their place** (3 plugs on each side) in the bodywork and make sure they are fixed.
11. If the new glass holds a heating element (Wolfram), then **connect the heating element female plugs on RH and LH side of the glass to the cables** (male plugs).
12. Remove the tape from the window.